

Distributed by:

**JAMECO<sup>®</sup>**  
**ELECTRONICS**

[www.Jameco.com](http://www.Jameco.com) ♦ 1-800-831-4242

The content and copyrights of the attached  
material are the property of its owner.

**Step Angle: 1.8°**  
**Insulation resistance: 500Vdc 100M ohms min.**  
**No. of phase: 4**  
**Voltage: 12V**  
**Current: 400mA**  
**Resistance: 30 ohms**  
**Inductance: 23mH**  
**Holding torque: 2000 g.cm**  
**Detent torque: <220 g.cm**  
**Leads: 26AWG UL 1007**

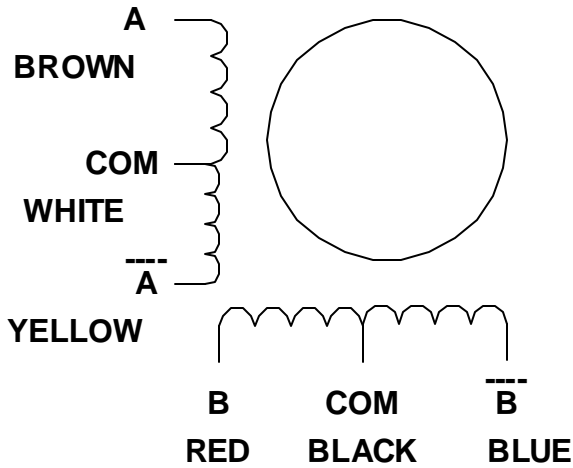
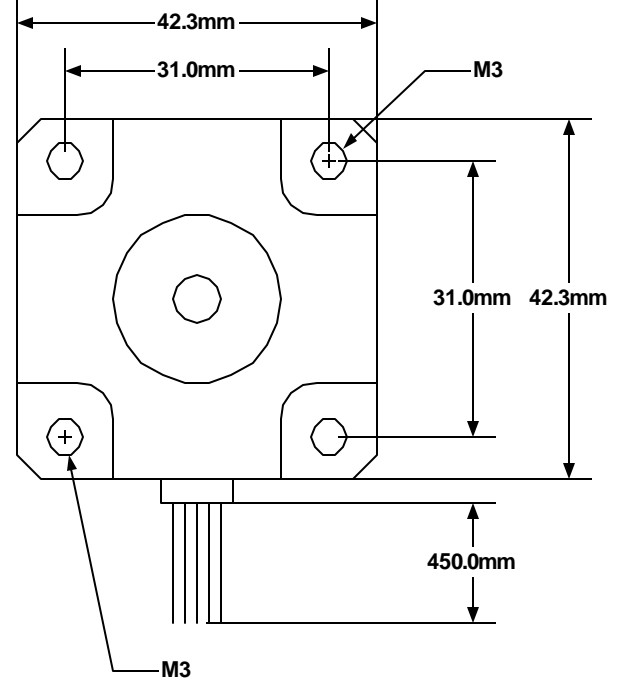
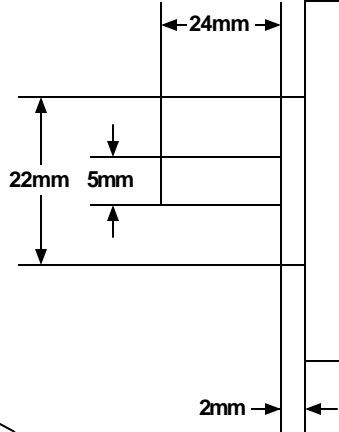

**PM Stepper Motor**

**Jameco Part Number 155432**

		SIZE mm		FSCM NO	DWG NO <b>42BYG228</b>	REV
		SCALE		SHEET		1 OF 1